

INDUSTRIAL PRESSURE TRANSMITTER

Swiss based Trafag is a leading international supplier of high quality sensors and monitoring instruments for measurement of pressure and temperature. The industrial pressure transmitter NAT 8252 features an exceptionally long-term stable thin-film-on-steel sensor cell with triple (optionally 5-fold) overpressure safety. Optionally, the NAT 8252 is available as a pressure switch with 1 or 2 switching outputs. The robust design and the wide temperature range from -40°C to +125°C qualify the NAT 8252 as the ideal solution for a wide range of demanding applications.



Applications

- Machine tools
- Hydraulics
- HVAC
- Refrigeration
- Process technology
- Water treatment

Features

- Smallest design
- Completely welded steel sensor system without additional seals
- Excellent long-term stability
- Optional: 5-fold overpressure resistance
- Optional: Switching output 1 or 2 PNP transistors

Technical Data			
Measuring principle	Thin-film-on-steel	Accuracy @ 25°C typ.	± 0.5 % FS typ.
Measuring range	0 ... 2.5 to 0 ... 600 bar 0 ... 30 to 0 ... 7500 psi	Media temperature	-40°C ... +125°C
Output signal	4 ... 20 mA, 0.5 ... 4.5 VDC, 0 ... 5 VDC, 0.5 ... 5 VDC, 1 ... 5 VDC, 0.5 ... 5.5 VDC, 1 ... 6 VDC, 0 ... 10 VDC, 1 ... 10 VDC, 0.1 ... 10.1 VDC, 0.5 ... 4.5 VDC ratiometric, Switching output: 1 or 2 PNP transistors	Ambient temperature	-40°C ... +125°C (Cable PVC 22: -5°C ... +60°C) (Cable PUR 24: -40°C ... +70°C) (Cable Radox Tenuis 88: -40°C ... +100°C)

06/2019

Data sheet H72303u

Subject to change

Ordering information/type code

				8252 . XX	XX	XX	XX	XX	XX	
Measuring range ¹⁾	Pressure measurement range [bar]	Over pressure [bar]	Burst pressure [bar]							
	0 ... 2.5	7.5	50	75						
	0 ... 4	12	60	76						
	0 ... 6	18	100	77						
	0 ... 10	30	200	78						
	0 ... 16	48	200	79						
	0 ... 25	75	300	80						
	0 ... 40	120	300	81						
	0 ... 60	180	400	82						
	0 ... 100	300	500	83						
	0 ... 160	480	750	85						
	0 ... 250	750	1000	74						
	0 ... 400	1000	2000	84						
	0 ... 600	1500	2500	86						
	Option 5P:	Fivefold overpressure								
	0 ... 2.5	12.5	60	55						
	0 ... 4	20	100	56						
	0 ... 6	30	200	57						
	0 ... 10	50	200	58						
	0 ... 16	80	300	59						
	0 ... 25	125	300	60						
	0 ... 40	200	400	61						
	0 ... 60	300	500	62						
	0 ... 100	500	750	63						
	0 ... 160	800	1000	65						
Sensor	Relative pressure								25	
Pressure connection	G1/4" male, seal: DIN 3869 (accessories 61/63/83)	17	7/16"-20UNF SAE4 male (J1926), seal: accessory 61	42						
	G1/4" male (Manometer) EN 837 ⁹⁾	53	9/16"-18UNF SAE6 male (J1926), seal: accessory 61	61						
	G1/8" male DIN3852-E ^{5) 9)}	54	R1/4" male, DIN3858 ⁵⁾	19						
	1/4" NPT male	30	R1/4" male, DIN2999 ⁹⁾	20						
	1/4" NPT female ^{5) 9)}	13	R1/8" male, DIN3858 ⁵⁾	16						
	1/8" NPT male ^{5) 9)}	43	M10x1 male, DIN EN ISO 6149-2, seal: accessory 61	32						
	7/16"-20UNF female SAE J512 with valve opener ⁴⁾	24	M12x1.5 male, DIN EN ISO 9974-2, seal: accessory 61 ⁹⁾	49						
	7/16"-20UNF female SAE J512 without valve opener ⁴⁾	44	M14x1.5 male DIN EN ISO 6149-2, seal: accessory 61 ⁹⁾	31						
	7/16"-20UNF male, DIN3866 ⁴⁾	18								
Electrical connection	Male electrical plug, industrial standard, contact distance 9.4 mm, Mat. PA			01						
	Male electrical plug M12x1, 4-pole, Mat. PA, IEC 61076-2-101			32						
	Male electrical plug M12x1, 5-pole, Mat. PA, IEC 61076-2-101			35						
	Male electrical plug MIL-C 26482, 6-pole, metal			02						
	Male electrical plug Deutsch DT04-3P, 3-pole			D3						
	Male electrical plug Deutsch DT04-4P, 4-pole			D4						
	Cable Mat. PVC, IP67/IP68, 2 x 2 x 0.14 mm ^{2 7)}			22						
	Cable Mat. PUR, IP67/IP68, 4 x 0.25 mm ^{2 7)}			24						
	Cable Mat. EPD Raychem FDR25, IP67, 4 x 0.2 mm ^{2 7)}			08						
	Cable Mat. Radox Tenuis, IP67/IP68, 4 x 0.5 mm ^{2 7)}			88						

Output signal	Signal output	Load resistance	I (supply)	U (supply)		
	4 ... 20 mA	See graphic		24 (9 ... 32) VDC	19	
	0.5 ... 4.5 VDC	≥ 5.0 kΩ to Us-	≤ 20 mA	24 (9 ... 32) VDC	20	
	0 ... 5 VDC	≥ 5.0 kΩ to Us-	≤ 20 mA	24 (9 ... 32) VDC	14	
	0.5 ... 5 VDC	≥ 5.0 kΩ to Us-	≤ 20 mA	24 (9 ... 32) VDC	22	
	1 ... 5 VDC	≥ 5.0 kΩ to Us-	≤ 20 mA	24 (9 ... 32) VDC	25	
	0.5 ... 5.5 VDC	≥ 5.0 kΩ to Us-	≤ 20 mA	24 (9 ... 32) VDC	24	
	1 ... 6 VDC	≥ 5.0 kΩ to Us-	≤ 20 mA	24 (9 ... 32) VDC	16	
	0 ... 10 VDC	≥ 5.0 kΩ to Us-	≤ 15 mA	24 (15 ... 32) VDC	17	
	1 ... 10 VDC	≥ 5.0 kΩ to Us-	≤ 15 mA	24 (15 ... 32) VDC	26	
	0.1 ... 10.1 VDC	≥ 5.0 kΩ to Us-	≤ 15 mA	24 (15 ... 32) VDC	13	
	0.5 ... 4.5 VDC ratiometric	≥ 5.0 kΩ to Us-	≤ 10 mA	5 (4.75 ... 5.25) VDC	23	
	2 PNP transistors ³⁾		≤ 10 mA	24 (9 ... 32) VDC	PS	
	1 PNP transistor ³⁾		≤ 10 mA	24 (9 ... 32) VDC	T1	
Accessories	Female electrical plug M12x1, 5-pole ²⁾				33	
	Female electrical connector industrial standard (for electrical connection 01)				34	
	Pressure peak damping element ø 1.0 mm ⁶⁾				40	
	Pressure peak damping element ø 0.4 mm ⁶⁾				44	
	Seal FPM, -18°C ... +125°C				61	
	Seal EPDM, -40°C ... +125°C				63	
	Seal NBR, -25°C ... +100°C				83	
	Special electrical connection: Pin 2 +, Pin 3 Ground, Pin 4 - (only for output signal 19 and male electrical plug 01, industrial standard)					90
	Special electrical connection: Pin 1 Out, Pin 2 +, Pin 3 Ground, Pin 4 - (only for output signals 13, 14, 16, 17, 20, 22, 23, 24, 25, 26 and male electrical plug 01, industrial standard)					91
	Special electrical connection: Pin 1 +, Pin 2 Ground, Pin 3 Out, Pin 4 - (only for output signals 13, 14, 16, 17, 20, 22, 23, 24, 25, 26 and male electrical plug 32, M12x1, 4-pole)					95
	Special electrical connection: Pin 1 +, Pin 2 Ground, Pin 3 -, Pin 4 Out (only for output signals 13, 14, 16, 17, 20, 22, 23, 24, 25, 26 and male electrical plug 32, M12x1, 4-pole)					96
	Special electrical connection: Pin 1 +, Pin 2 -, Pin 4 Ground (only for output signal 19 and male electrical plug 01, industrial standard)					92
	Special electrical connection: Pin 1 +, Pin 2 -, Pin 4 Ground (only for output signal 19 and male electrical plug 32, M12x1, 4-pole)					E1
	Special electrical connection: Pin 1 +, Pin 2 -, Pin 3 Out, Pin 4 Ground (only for output signals 13, 14, 16, 17, 20, 22, 23, 24, 25, 26 and male electrical plug 32, M12x1, 4-pole)					E2
	Special electrical connection: Pin 1 Out, Pin 2 -, Pin 3 +, Pin 4 Ground (only for output signals 13, 14, 16, 17, 20, 22, 23, 24, 25, 26 and male electrical plug 01, industrial standard)					E3
	Special electrical connection: Pin 1 +, Pin 2 Ground, Pin 4 - (only for output signal 19 and male electrical plug 32, M12x1, 4-pole)					E6
	Special electrical connection: Pin A +, Pin C - (only for output signal 19 and male electrical plug Deutsch DT04-3P, 3-pole)					F0
	Special electrical connection: Pin A +, Pin B Out, Pin C - (only for output signals 13, 14, 16, 17, 20, 22, 23, 24, 25, 26 and male electrical plug Deutsch DT04-3P, 3-pole)					F1
	Cable length 0.5 m					EM
	Cable length 1.0 m					1M
	Cable length 2.0 m					2M
	Parameterization according to customer specification for output signal PS, T1 (see table "Parameters")					ZC
	Parameterization standard for output signal PS, T1 (see table "Parameters")					ZS
	Multiple packaging ⁸⁾					VM

¹⁾ Customized pressure ranges upon request

²⁾ For electrical connections 32 and 35

³⁾ Only with electrical connections 32, 22, 24, 08, 88

⁴⁾ Max. allowable pressure range 60 bar at 180 bar overpressure

⁵⁾ Max. allowable pressure range 160 bar at 480 bar overpressure

⁶⁾ Not for pressure connections 53, 24, 44, 18

⁷⁾ Cable length see accessories

⁸⁾ The order quantity must be a multiple of 50, only for electrical connections 01, 32, 35, 02, D3, D4, not for pressure connection 30 with electrical connections 02, D3, D4

⁹⁾ Upon request

Standard products (extra short lead time)

Product No.	Type Code	Pressure range [bar]	Over pressure max. [bar]	Supply [VDC]	Accuracy @ 25°C typ. [%]
NAT2.5A	8252 75 2517 01 0000 0000 19 34 44 61	0 ... 2.5	7.5	9 ... 32	±0.5
NAT4.0A	8252 76 2517 01 0000 0000 19 34 44 61	0 ... 4	12	9 ... 32	±0.5
NAT6.0A	8252 77 2517 01 0000 0000 19 34 44 61	0 ... 6	18	9...32	±0.5
NAT10.0A	8252 78 2517 01 0000 0000 19 34 44 61	0 ... 10	30	9...32	±0.5
NAT16.0A	8252 79 2517 01 0000 0000 19 34 44 61	0 ... 16	48	9 ... 32	±0.5
NAT25.0A	8252 80 2517 01 0000 0000 19 34 44 61	0 ... 25	75	9 ... 32	±0.5
NAT40.0A	8252 81 2517 01 0000 0000 19 34 44 61	0 ... 40	120	9 ... 32	±0.5
NAT100.0A	8252 83 2517 01 0000 0000 19 34 44 61	0 ... 100	300	9 ... 32	±0.5
NAT250.0A	8252 74 2517 01 0000 0000 19 34 44 61	0 ... 250	750	9 ... 32	±0.5
NAT400.0A	8252 84 2517 01 0000 0000 19 34 44 61	0 ... 400	1000	9 ... 32	±0.5
NAT600.0A	8252 86 2517 01 0000 0000 19 34 44 61	0 ... 600	1500	9 ... 32	±0.5
NAT2.5V	8252 75 2517 01 0000 0000 17 34 44 61	0 ... 2.5	7.5	15 ... 32	±0.5
NAT4.0V	8252 76 2517 01 0000 0000 17 34 44 61	0 ... 4	12	15 ... 32	±0.5
NAT6.0V	8252 77 2517 01 0000 0000 17 34 44 61	0 ... 6	18	15 ... 32	±0.5
NAT10.0V	8252 78 2517 01 0000 0000 17 34 44 61	0 ... 10	30	15 ... 32	±0.5
NAT16.0V	8252 79 2517 01 0000 0000 17 34 44 61	0 ... 16	48	15 ... 32	±0.5
NAT25.0V	8252 80 2517 01 0000 0000 17 34 44 61	0 ... 25	75	15 ... 32	±0.5
NAT40.0V	8252 81 2517 01 0000 0000 17 34 44 61	0 ... 40	120	15 ... 32	±0.5
NAT100.0V	8252 83 2517 01 0000 0000 17 34 44 61	0 ... 100	300	15 ... 32	±0.5
NAT250.0V	8252 74 2517 01 0000 0000 17 34 44 61	0 ... 250	750	15 ... 32	±0.5
NAT400.0V	8252 84 2517 01 0000 0000 17 34 44 61	0 ... 400	1000	15 ... 32	±0.5
NAT600.0V	8252 86 2517 01 0000 0000 17 34 44 61	0 ... 600	1500	15 ... 32	±0.5
NAT2.5AM	8252 75 2517 32 0000 0000 19 33 44 61	0 ... 2.5	7.5	9 ... 32	±0.5
NAT4.0AM	8252 76 2517 32 0000 0000 19 33 44 61	0 ... 4	12	9 ... 32	±0.5
NAT6.0AM	8252 77 2517 32 0000 0000 19 33 44 61	0 ... 6	18	9 ... 32	±0.5
NAT10.0AM	8252 78 2517 32 0000 0000 19 33 44 61	0 ... 10	30	9 ... 32	±0.5
NAT16.0AM	8252 78 2517 32 0000 0000 19 33 44 61	0 ... 16	48	9 ... 32	±0.5
NAT25.0AM	8252 80 2517 32 0000 0000 19 33 44 61	0 ... 25	75	9 ... 32	±0.5
NAT40.0AM	8252 81 2517 32 0000 0000 19 33 44 61	0 ... 40	120	9 ... 32	±0.5
NAT60.0AM	8252 82 2517 32 0000 0000 19 33 44 61	0 ... 60	180	9 ... 32	±0.5
NAT100.0AM	8252 83 2517 32 0000 0000 19 33 44 61	0 ... 100	300	9 ... 32	±0.5
NAT160.0AM	8252 85 2517 32 0000 0000 19 33 44 61	0 ... 160	480	9 ... 32	±0.5
NAT250.0AM	8252 74 2517 32 0000 0000 19 33 44 61	0 ... 250	750	9 ... 32	±0.5
NAT400.0AM	8252 84 2517 32 0000 0000 19 33 44 61	0 ... 400	1000	9 ... 32	±0.5
NAT600.0AM	8252 86 2517 32 0000 0000 19 33 44 61	0 ... 600	1500	9 ... 32	±0.5

Standard products (extra short lead time)

Product No.	Type Code	Pressure range [bar]	Over pressure max. [bar]	Supply [VDC]	Accuracy @ 25°C typ. [%]
NAT2.5PS	8252 75 2517 32 0000 0000 PS 44 61 ZS	0 ... 2.5	7.5	9 ... 32	±0.5
NAT4.0PS	8252 76 2517 32 0000 0000 PS 44 61 ZS	0 ... 4	12	9 ... 32	±0.5
NAT6.0PS	8252 77 2517 32 0000 0000 PS 44 61 ZS	0 ... 6	18	9 ... 32	±0.5
NAT10.0PS	8252 78 2517 32 0000 0000 PS 44 61 ZS	0 ... 10	30	9 ... 32	±0.5
NAT16.0PS	8252 79 2517 32 0000 0000 PS 44 61 ZS	0 ... 16	48	9 ... 32	±0.5
NAT25.0PS	8252 80 2517 32 0000 0000 PS 44 61 ZS	0 ... 25	75	9 ... 32	±0.5
NAT40.0PS	8252 81 2517 32 0000 0000 PS 44 61 ZS	0 ... 40	120	9 ... 32	±0.5
NAT60.0PS	8252 82 2517 32 0000 0000 PS 44 61 ZS	0 ... 60	180	9 ... 32	±0.5
NAT100.0PS	8252 83 2517 32 0000 0000 PS 44 61 ZS	0 ... 100	300	9 ... 32	±0.5
NAT160.0PS	8252 85 2517 32 0000 0000 PS 44 61 ZS	0 ... 160	480	9 ... 32	±0.5
NAT250.0PS	8252 74 2517 32 0000 0000 PS 44 61 ZS	0 ... 250	750	9 ... 32	±0.5
NAT400.0PS	8252 84 2517 32 0000 0000 PS 44 61 ZS	0 ... 400	1000	9 ... 32	±0.5
NAT600.0PS	8252 86 2517 32 0000 0000 PS 44 61 ZS	0 ... 600	1500	9 ... 32	±0.5

Parameters				
Name	Standard setting (accessory ZS)	Value range	Short name	Customer adjustment (accessory ZC)
Switch point SP1 (hysteresis mode) Upper switch point FH1 (window mode)	75 % Measuring range	> RP1, FL1 (2 ... 99 %) Hysteresis \geq 1 % FS	SP1	
Reset point RP1 (hysteresis mode) Lower switch point FL1 (window mode)	25 % Measuring range	< SP1, FH1 (1 ... 98 %) Hysteresis \geq 1 % FS	RP1	
Switch point SP2 (hysteresis mode) Upper switch point FH2 (window mode)	75 % Measuring range	> RP2, FL2 (2 ... 99 %) Hysteresis \geq 1 % FS	SP2	
Reset point RP2 (hysteresis mode) Lower switch point FL2 (window mode)	25 % Measuring range	< SP2, FH2 (1 ... 98 %) Hysteresis \geq 1 % FS	RP2	
Switch point delay time SP1 / RP1 (hysteresis mode) Switch point delay time FH1 / FL1 (window mode)	0	0; approx. 2 ^x [ms], x = 3, 4 ... 16	dS1	
Switch point delay time SP2 / RP2 (hysteresis mode) Switch point delay time FH2 / FL2 (window mode)	0	0; approx. 2 ^x [ms], x = 3, 4 ... 16	dS2	
Functions switching output 1	Hysteresis, closer (Hno)	Hysteresis NO (Hno), Hysteresis NC (Hnc) Window NO (Fno), Window NC (Fnc)	ou1	
Functions switching output 2	Hysteresis, closer (Hno)	Hysteresis NO (Hno), Hysteresis NC (Hnc) Window NO (Fno), Window NC (Fnc) Device ready	ou2	

i Parameterization of switching points

The switching points, delay times and output functions can be parameterized via Smartphone app (Android). The SMI Sensor Master Interface required for the parameterization as well as the Smartphone are not part of the delivery. The Android App is available for free in the Google Play Store.

- Ordering No. SMI Sensor Master Interface: F90170
- Data sheet SMI Sensor Master Interface: H72618



Specifications		
Electrical Data	Output / supply voltage	4 ... 20 mA: 24 (9...32) VDC 0.5 ... 4.5 VDC: 24 (9...32) VDC 0 ... 5 VDC: 24 (9...32) VDC 0.5 ... 5 VDC: 24 (9...32) VDC 1 ... 5 VDC: 24 (9...32) VDC 0.5 ... 5.5 VDC: 24 (9...32) VDC 1 ... 6 VDC: 24 (9...32) VDC 0 ... 10 VDC: 24 (15...32) VDC 1 ... 10 VDC: 24 (15...32) VDC 0.1 ... 10.1 VDC: 24 (15...32) VDC 0.5 ... 4.5 VDC ratiom., 10 ... 90% U _{supply} : 5 ± 0.25 VDC 1 or 2 PNP transistors: 24 (9...32) VDC
	Rise time	Typ. 1 ms / 10 ... 90 % nominal pressure
	Switch-on-delay pressure transmitters	100 ms
	Switch-on-delay pressure switches	50 ms + switching delay time
	Inverse-polarity protection, short-circuit strength @ 25°C during 5 min.	4...20 mA: to U _s = 32 VDC 0.5...4.5 VDC, 0...5 VDC, 0.5...5 VDC, 1...5 VDC, 0.5...5.5 VDC, 1...6 VDC, 0...10 VDC, 1...10 VDC, 0.1...10.1 VDC: to U _s = 28 VDC 0.5...4.5 VDC ratiometric: to U _s = 14 VDC 1 or 2 PNP transistors: to U _s = 32 VDC
Environmental conditions	Media temperature	-40°C ... +125°C
	Ambient temperature	-40°C ... +125°C (Cable PVC 22: -5°C ... +60°C) (Cable PUR 24: -40°C ... +70°C) (Cable Radox Tenuis 88: -40°C ... +100°C)
	Protection ¹⁾	IP65, IP67, IP68
	Humidity	Max. 95 % relative
	Vibration	15 g RMS (20...2000 Hz) (EN60068-2-64) 25 g sin (80...2000 Hz), 1 oct./min, (1x @ 25°C) (EN60068-2-6)
	Shock	50 g / 11 ms 100 g / 6 ms Male electrical plug M12x1 (EN60068-2-27) ²⁾
EMC Protection	Emission	EN/IEC 61000-6-3
	Immunity	EN/IEC 61000-6-2
Mechanical Data	Sensor (wetted parts)	1.4542 (AISI630)
	Pressure connection (wetted parts)	1.4542 (AISI630)
	Housing	1.4301 (AISI304)
	Sealing	FPM/EPDM/NBR
	Male electrical plug	See ordering information
	Weight	appr. 50 g
	Mounting torque	25 Nm

¹⁾ See electrical connection

²⁾ For electrical connections 32 and 35

Analogue output

Accuracy	TEB @ -25 ... +85°C	[% FS typ.]	± 1.75
	Accuracy @ +25°C	[% FS typ.]	± 0.5
	NLH @ +25°C (BSL)	[% FS typ.]	± 0.2
	TC zero point and span	[% FS/K typ.]	± 0.03
	Long term stability 1 year	[% FS typ.]	± 0.1
Rise time	Typ. 1 ms / 10 ... 90 % nominal pressure		

Switching output

Accuracy	TEB @ -25 ... +85°C	[% FS typ.]	± 1.75
	Accuracy @ +25°C	[% FS typ.]	± 0.5
	Long term stability 1 year	[% FS typ.]	± 0.1
Adjustment range of switchpoints	1 ... 99 % FS		
Distance switch point	≥ 1.0 % FS		
Switch point > reset point	Switchpoint > reset point		
Switching resistance	≤ 3 Ω		
Output function	Hysteresis, Window; normally closed (NO), normally open (NC)		
Switching current	-40°C ... +85°C	(Ambient and media temperature)	≤ 400 mA, total of both switching outputs
	+85°C ... +125°C	(Ambient and media temperature)	≤ 200 mA, total of both switching outputs
Current limiting	integrated		
Delay time	0; approx. 2 ^x [ms], x = 3, 4 ... 16		
Switching frequency	max. 60 Hz (at switching delay time = 0)		

Measuring accuracy

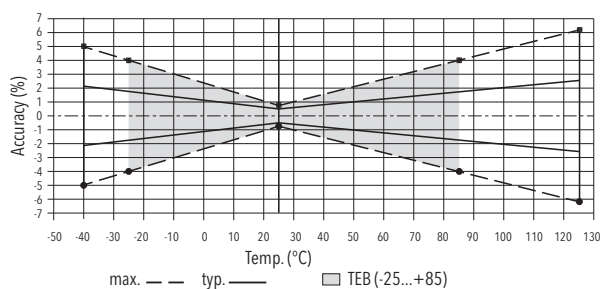

Dimensions

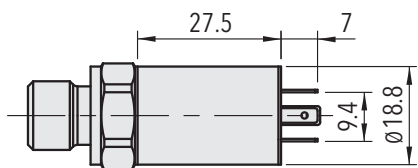

8252.XX.XXXX.01.XX.XX

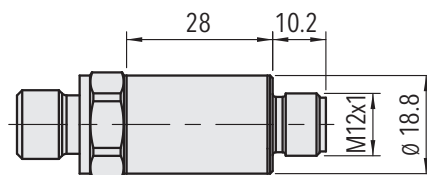

8252.XX.XXXX.32/35.XX.XX

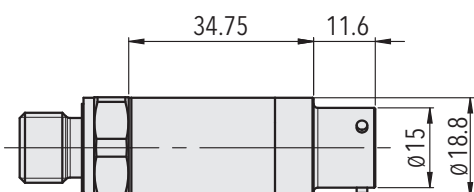

8252.XX.XXXX.02.XX.XX

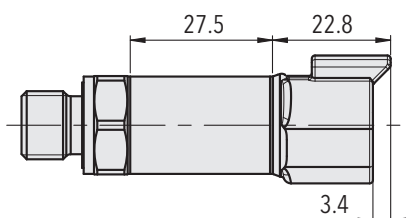

8252.XX.XXXX.D3.XX.XX

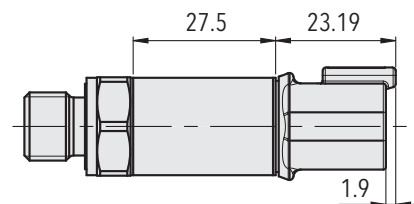

8252.XX.XXXX.D4.XX.XX

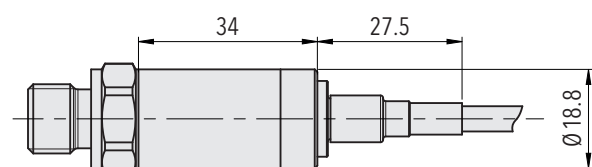

8252.XX.XXXX.08.XX.XX

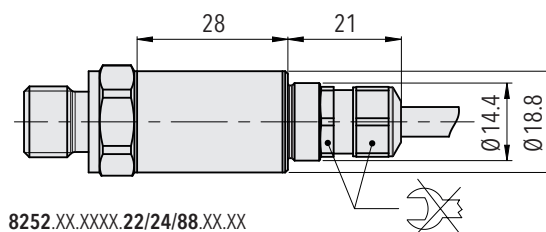

8252.XX.XXXX.22/24/88.XX.XX

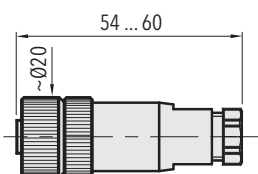

8252.XX.XXXX.XX.XX.33

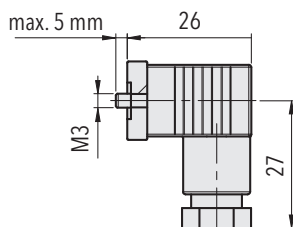

8252.XX.XXXX.XX.XX.34

Dimensions

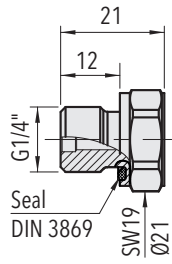

8252.XX.XX17.XX.XX.XX

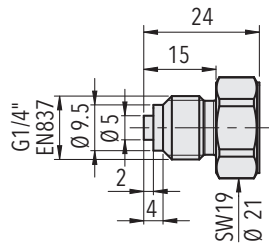

8252.XX.XX53.XX.XX.XX

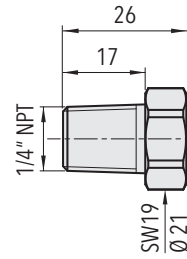

8252.XX.XX30.XX.XX.XX

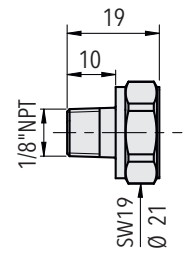

8252.XX.XX43.XX.XX.XX

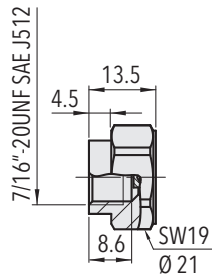

8252.XX.XX24.XX.XX.XX

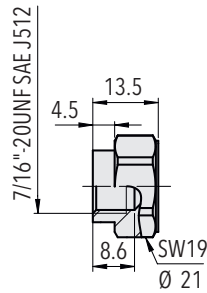

8252.XX.XX44.XX.XX.XX

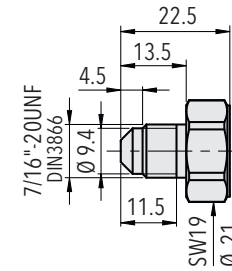

8252.XX.XX18.XX.XX.XX

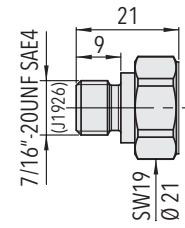

8252.XX.XX42.XX.XX.XX

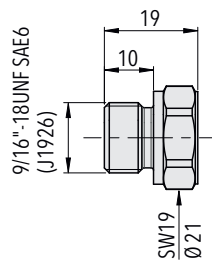

8252.XX.XX61.XX.XX.XX

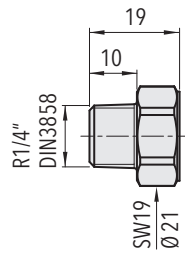

8252.XX.XX19.XX.XX.XX

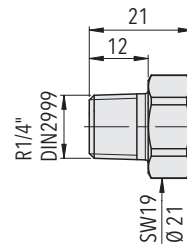

8252.XX.XX20.XX.XX.XX

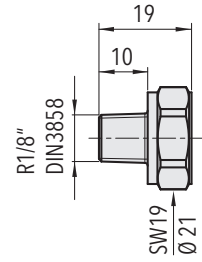

8252.XX.XX16.XX.XX.XX

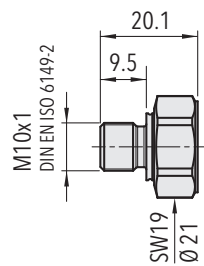

8252.XX.XX32.XX.XX.XX

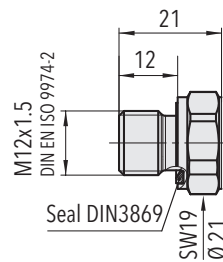

8252.XX.XX49.XX.XX.XX

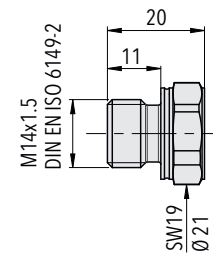

8252.XX.XX31.XX.XX.XX

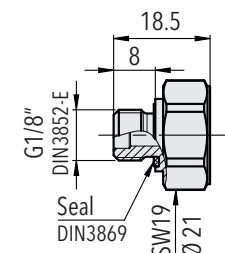



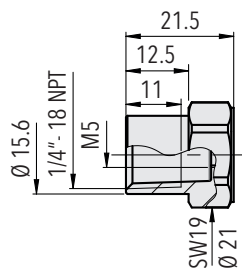

8252.XX.XX54.XX.XX.XX

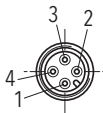
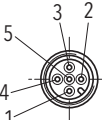

8252.XX.XX13.XX.XX.XX

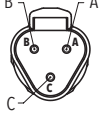
Electrical connection

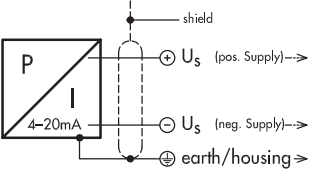
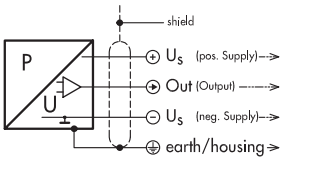
		Protection / electrical connection										
		IP65 ^{1) 2)}		IP67 ^{1) 2)}				IP67 ^{1) 2)}	IP67, IP68 ^{1) 4)}		IP67, IP68 ^{1) 4)}	
		Industrial standard Contact distance 9.4 mm		M12x1				MIL-C 26482	DT04-3P 3-pole		DT04-4P 4-pole	
		01		32		35		02	D3		D4	
												
Output signal	 <p>8252.xx.XXXX.xx.19</p>	90	92	E1	E6					F0		
		2	2	1	1	1	1	4	A	A	A	2
		1	4	2	3	2	4	1	B	B	C	1
		4	3	4	4	4	2	5	E			3
Output signal	 <p>8252.xx.XXXXX.13/14/16/17/20/ 22/23/24/25/26</p>	91	E3	95	96	E2				F1		
		1	2	3	1	1	1	2	A	A	A	2
		2	1	1	2	3	4	3	B	C	B	4
		3	4	2	3	4	3	2	C/D	B	C	1
		4	3	4	4	2	2	4	E			3

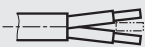
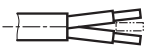
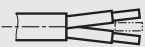
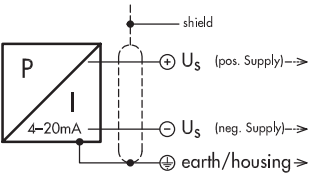
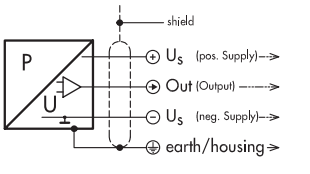
		Protection / electrical connection		
		IP67, IP68 ^{2) 3)}	IP67 ²⁾	IP67, IP68 ^{2) 3)}
		Cable	Cable	Cable
		22/24	08	88
				
Output signal	 <p>8252.xx.XXXX.xx.19</p>	white	red	brown
		brown yellow	black green	black yellow / green
Output signal	 <p>8252.xx.XXXXX.13/14/16/17/20/ 22/23/24/25/26</p>	white green brown yellow	red white black green	brown blue black yellow / green

¹⁾ Provided female connector is mounted according to instructions

²⁾ Ventilation via male electric plug/cable end

³⁾ IP68, 20 bar, 30 min.

⁴⁾ IP68, 100 mbar, 4h

Electrical connection

		Protection / electrical connection							
		IP67 ^{1) 2)}		IP67, IP68 ^{2) 3)}		IP67 ²⁾		IP67, IP68 ^{2) 3)}	
		M12x1 4-pole 32		Cable 22/24		Cable 08		Cable 88	
Output signal		PS	T1	PS	T1	PS	T1	PS	T1
	8252.XX.XXXX.XX.PS/T1	1 4 2 3	1 4 - 3	white green yellow brown	white green - brown	red white green black	red white - black	brown blue yellow / green black	brown blue - black

¹⁾ Provided female connector is mounted according to instructions

²⁾ Ventilation via male electric plug/cable end

³⁾ IP68, 20 bar, 30 min.

4...20mA: min./max resistor vs. supply voltage @ Pmax = 100%

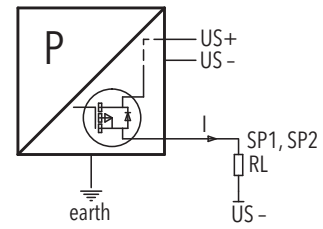
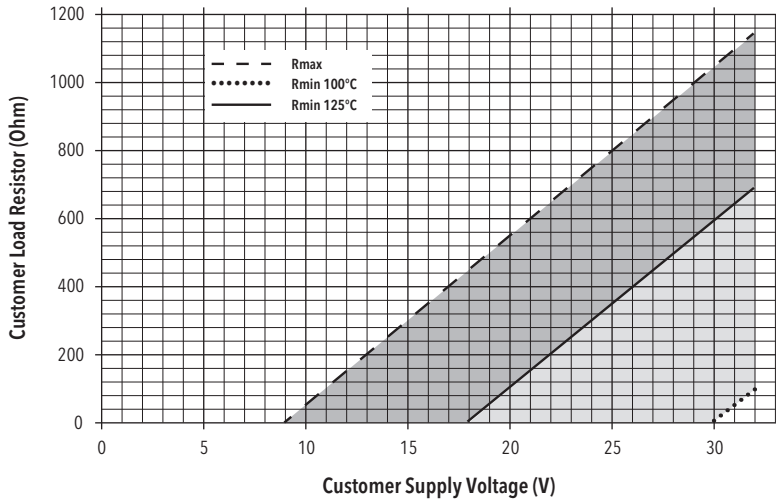

Connection of loads to switch contacts

Functions switching output

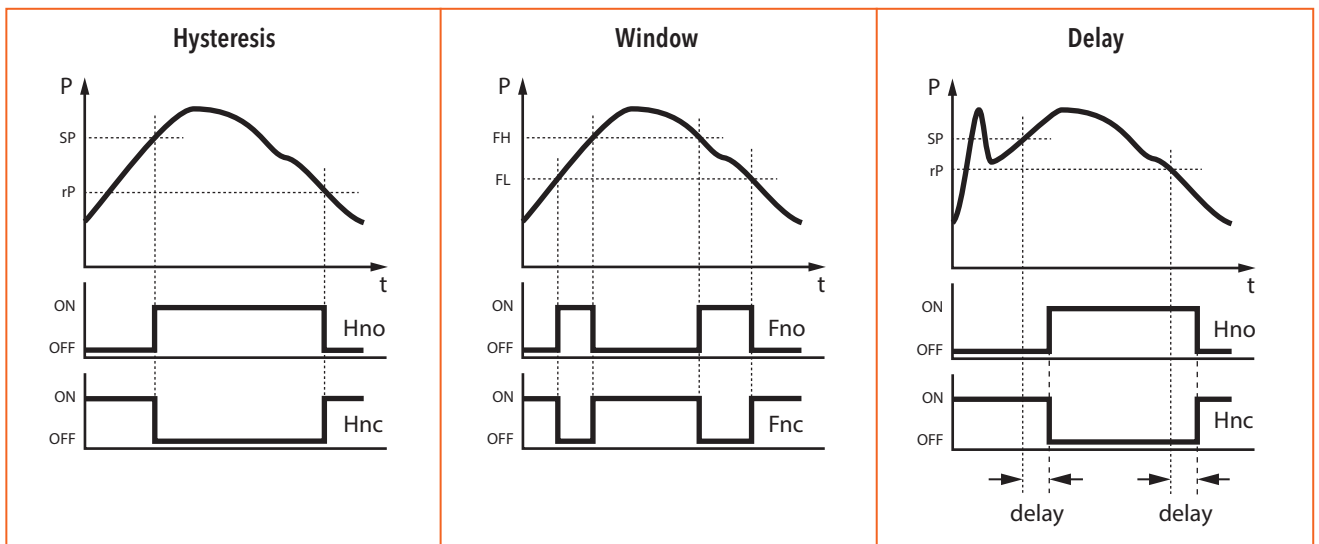

Additional information

Documents

Data sheet	www.trafag.com/H72303
Instructions	www.trafag.com/H73303
Flyer	www.trafag.com/H70666